

We wish to thank you for purchasing and investing your trust in JAAZ Sandwich Rain Shower. We will do everything in our power to uphold this trust. Please read installation and care instruction carefully, because damage to surface & underlying material results from improper treatment is not covered by warranty .

**Care instruction**

Do not use any abrasive sponges or scouring agents for cleaning. We also advise you not to use cleaning agents containing solvent or acid, lime scale removers, household vinegar and cleaning agents containing agents with acetic acid in them. They are aggressive to the surface and will leave your Rain Shower dull & scratched. As the formulate of commercially available cleaning agents frequently change, we cannot guarantee they will provide the gentle care to our Rain Shower deserve. Clean the Rain Shower with a little soap and a moist cloth only. Then simply rinse off and wipe dry. You can avoid lime spots by drying the shower each time it is used . Water Supply: Minimum Pressure 3 bar, Maximum Pressure 4bar. Water Hardness: If water hardness exceeds 180mg/L, we strongly recommend the use of water softening system. Warranty does not cover any damage caused due to water hardness.

**Warranty - 3 years**

Proven manufacturing & Material defects would be replaced free of cost during 3 year warranty period, provided above care instruction are followed properly .

\_\_\_\_\_ Place & Date \_\_\_\_\_ Dealer Stamp & Sign

**FOR FURTHER SUPPORT**

**CALL US ON**  
+91 9408630765  
+91 7930256667  
+91 2652280178

**WRITE TO US AT**  
support@jaaz.in

www.jaaz.in

**REGISTERED OFFICE**  
406 Onyx, Akshar Cross Road,  
O. P. Road, Vadodara 390020,  
Gujarat. INDIA.

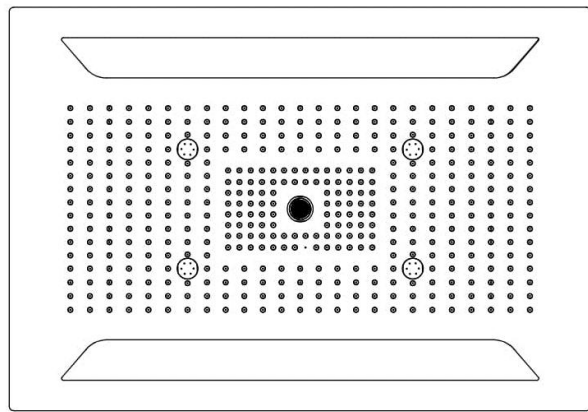

Multifunction Rain Shower  
**MF-WCM**

# Parts List

**Model : MF-WCM**  
 Size : 650.00mm x 450.00mm  
 Function: Rain / Intense / Water Column / 4 Mist

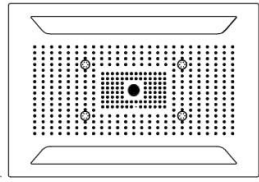

Shower head

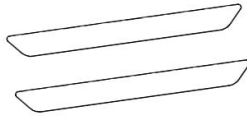

Side LED Cover



Strong Anchor



Wire



X 12

Nut



X 20

Washer



Stud bolt



X 8

Bolt



Filter

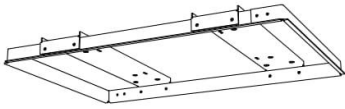

Bracket



LED Remote



12V Adaptor



Allen Key

# Dimensions

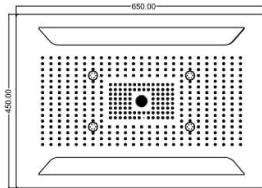
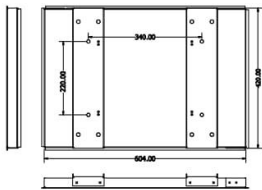

➔ For assembly you will need:

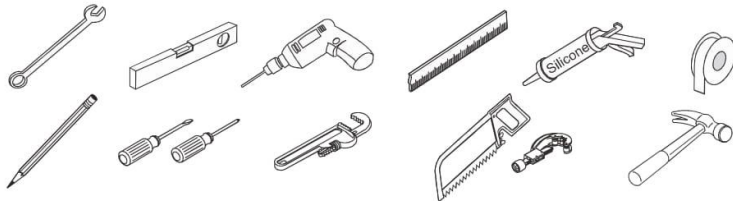

# Installation Guide

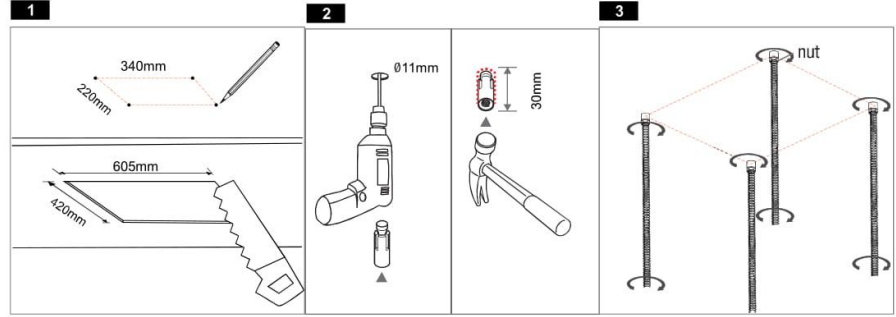

Cut the false to install the bracket and mark 4 position on the upper ceiling for strong anchor.  
 Bracket Size : 605mm x 420mm  
 Position Size : 340mm x 220mm

Make the 4 holes (11dia, 30mm dip) on the 4 marks. Put the 4 strong anchors into the holes and hit them with a hammer.

Screw 4 stud bolts to the anchor bolts and fasten each bolt.

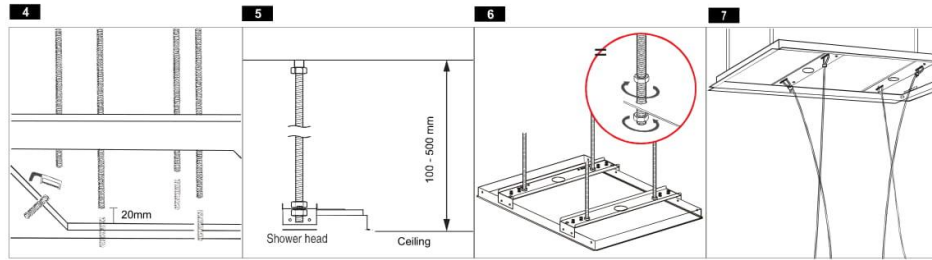

Check the length between the false ceiling and built-in bracket. Cut the stud bolt according to the measured value. Put one nut to each stud bolt. There must be 20mm gap between stud bolt and ceiling

Put the bracket to the ceiling.

Tighten the stud bolts with 4 nuts and adjust the height

Hang wires of shower head on the bracket.

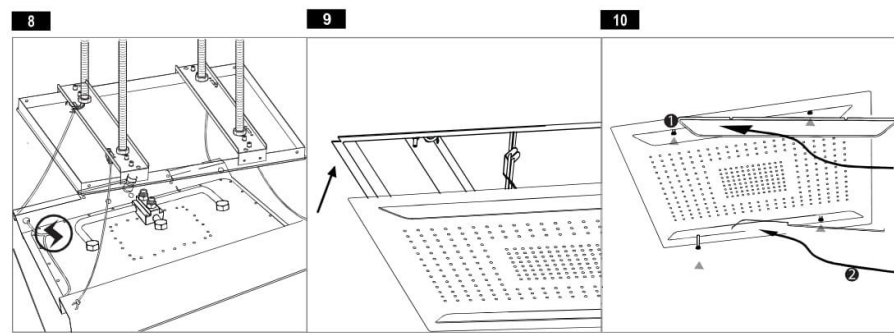

1. Intense Shower

2. Rain Shower

3. Water Column

4. Mist

Connect water supply hoses and power supply to the shower head.

Put the shower head to the bracket.

1) Fix the shower head with 8 bolts with washer.  
 2) Insert 2 LED covers.

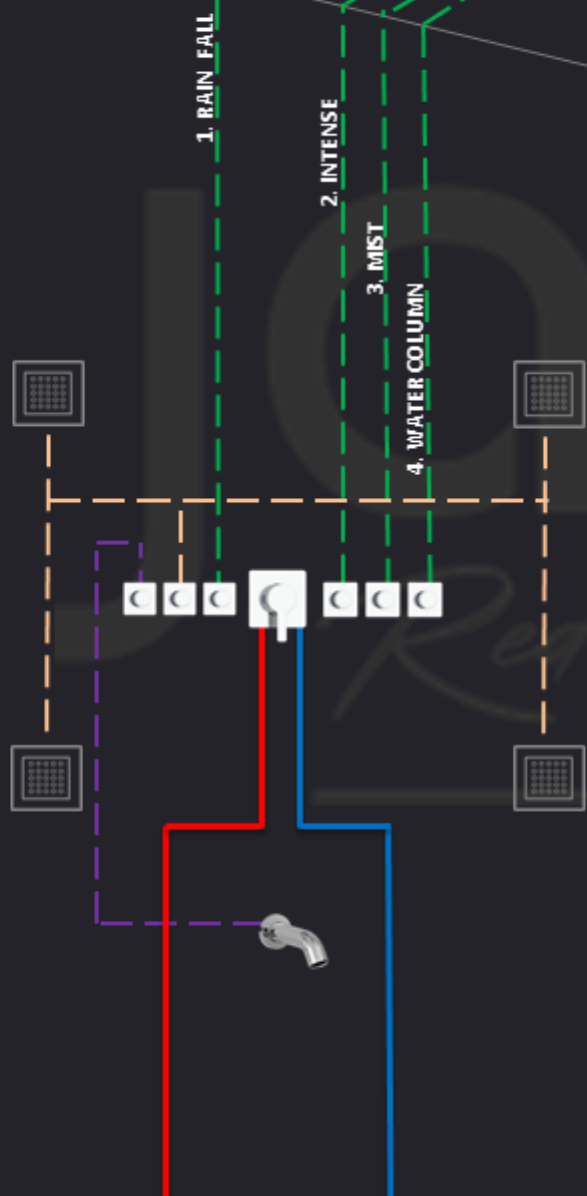
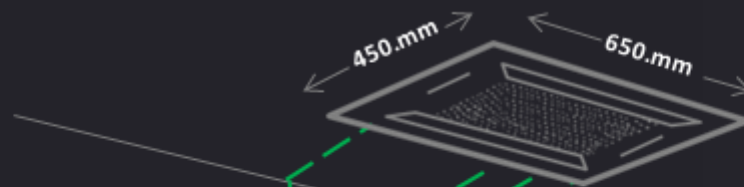

**WATER INLET PIPE** (3/4 inch)

- HOT Water Inlet
- COLD Water Inlet

**WATER OUTLET PIPE** (1/2 inch)

- Multifunction Rain Shower

1. RAIN FALL
2. INTENSE
3. MIST
4. WATER COLUMN

- Body Jets

- Spout